



*Moka Express*

Contact: [https://www.bialetti.com/it\\_en/contact](https://www.bialetti.com/it_en/contact)

The latest video available:

[https://www.bialetti.com/it\\_en/moka-express-experience](https://www.bialetti.com/it_en/moka-express-experience)

## Check Bialetti Components



## Safety Guidelines

- Keep these instructions on hand for the entire life of the Bialetti.
- Before first use check that the Bialetti is not damaged, and all its parts are included and in good condition.
- Remove all packaging materials and instructions before use.
- Only operate the Bialetti on appropriate surfaces and out of the reach of children, since its base will get very hot.
- Never use other liquids in the boiler. It is intended to be used only with water; using it without water will damage the rubber gasket.
- Never use barley, cocoa, tea or coffee extracts. The Bialetti is only intended for coffee.
- Always use the handle to move the Bialetti to avoid burns; the other parts will get hot after usage.
- Make sure the pouring spout is not oriented towards the user, and that the lid is properly closed to avoid burns.
- After brewing, discard the coffee carefully without bumping the funnel as any dents will jeopardize proper sealing.
- Check the filter plate regularly; clean with a brush if holes are clogged.
- Check and clean the safety valve to prevent formation of lime deposits, by pushing on the small piston from the inside of the boiler.
- Replace the rubber gasket once a year or when it is worn out.
- Buy only original Bialetti spare parts.

# Making Coffee in the Bialetti

1. Add tap or filtered water to the boiler, up to the safety valve. In the unlikely event that too much pressure develops in the boiler, the safety valve opens to release pressure and prevent user injury.

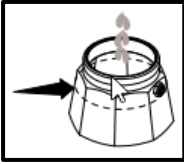

**First time using the Bialetti:** Wash with warm water and make 2–3 cups of coffee; discard these first cups of coffee.

2. Insert the funnel into the boiler and fill the funnel with 16 gr of fine grind coffee.

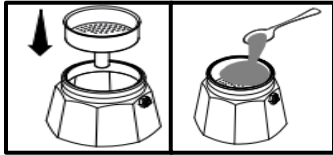

**Do not overfill the funnel with coffee since it can compromise the rubber gasket.**

3. Screw the coffee pot into the boiler and tighten it well to prevent leaks along the seam.



**Avoid tightening the coffee pot and boiler by using the handle. This could damage the handle.**

4. Put the Bialetti over the burner. For best results, use low heat to allow the water to filter slowly from the boiler into the funnel, and up to the coffee pot.

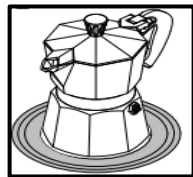

**The flame or burner shouldn't go beyond the edges of the boiler to avoid damaging the handle.**

5. Wait 5–10 minutes until you hear a bubbling sound. When the coffee pot is almost full of coffee turn off the heat and let the Bialetti cool down. Enjoy your coffee!
6. Once the Bialetti is cool, unscrew the coffee pot and discard the coffee ground. Clean with warm water and nonabrasive detergents.

